

Cromwell Road

ST. ANDREWS

APPROXIMATE FLOOR AREA
56 SQM / 602 SQFT



GROUND FLOOR
561 sq.ft. (52.1 sq.m.) approx.

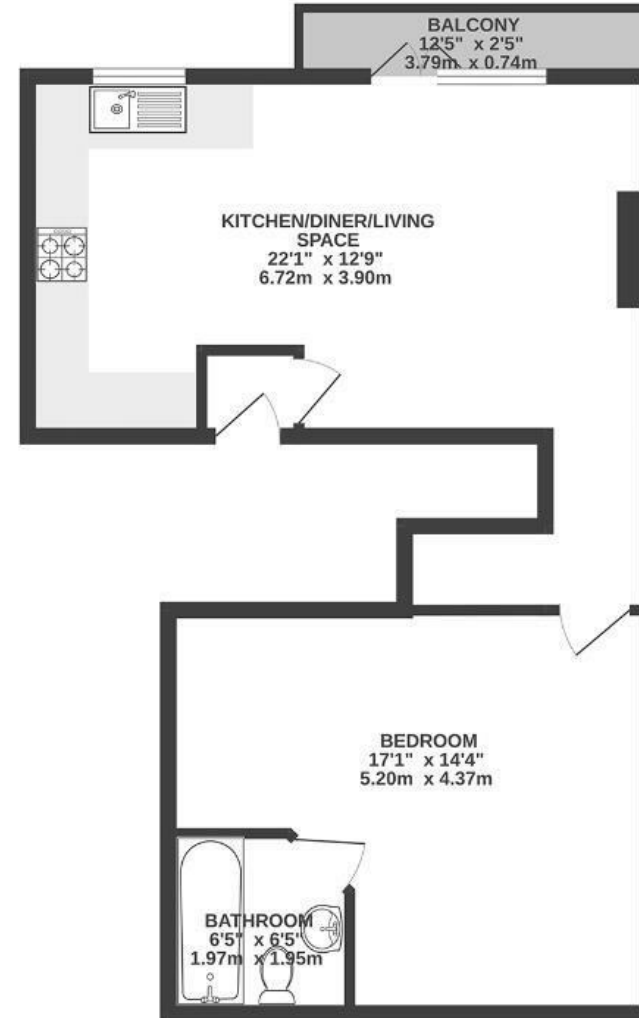

Illustrations are for reference purposes only,
measurements are approximate, not to scale.

Boardwalk

Cromwell Road

ST. ANDREWS, BRISTOL



£265,000



1 Bedrooms



BS6 5HD



1 Bathrooms

"We viewed our flat in the middle of summer and instantly fell in love. Gloucester Road was alive – the sun was out, pubs were bustling, and there was a real buzz that we'd been seeking since leaving London. That, contrasted with a sun-filled balcony and luscious green outlook has given us the perfect balance. Whether entertaining friends and family or sitting in our rocking chair with a coffee, it's always been a space full of joy. We feel so lucky to have lived here for the last five years."

